

Protecta FR Acrylic 150mm Solid Timber or CLT Floor Plastic Pipes PVC-U, PE-HD, PEX, PP, PP-R, etc

Installation Instructions

1. Before installing Protecta® FR Acrylic ensure that the surface of all service penetrations and surrounding construction is free from all loose contaminants, dust and grease.
2. Install the backing material. Cut this slightly oversize and insert into the gap ensuring a tight friction fit. Ensure correct depth is achieved.
3. Fill the gap or joint with Protecta® FR Acrylic on both sides to the required depth.
4. Apply the sealant generously to prevent air bubbles. Finish the bead with a moist spatula, pallet knife or brush.
5. Protecta® FR Acrylic can be over-painted with most emulsion or alkyd (gloss) paints.

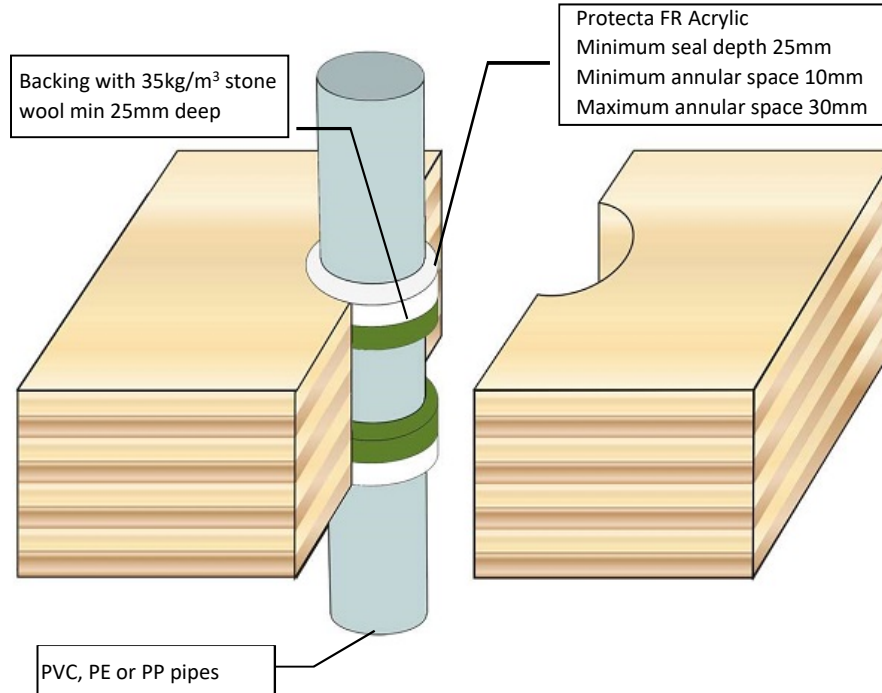

System/FPA Register ID# FC416

Products	Protecta FR Acrylic Stone wool
Application	Fire stopping of plastic pipes in timber floors
Construction	Minimum floor thickness of 150mm comprised of solid timber or CLT with a minimum density of 480kg/m ³ .

Fire & Sound Classification

Pipe PVC-U, PVC-C up to 32mm with wall thickness up to 2.4mm FRR -/120/120

Pipe PE, PE-LD, PE-MD, PE-HD, PEX, ABS, SAN +PVC up to 32mm with wall thickness up to 3.0mm FRR -/180/180

Pipe PP, PP-R, PP-H, PP-MV up to 75mm with wall thickness up to 4.4mm FRR -/120/120

ZERO smoke leakage up to 200Pa

Sound reduction (seal only) STC 62

As a part of our policy of on-going product development and testing, we reserve the right to modify, alter or change product specifications without giving notice. All information contained in this document is given in good faith and is provided for guidance only. Any drawings provided are for illustrative purposes only. As Polyseam has no control over the methods or competence of installation and of prevailing site conditions, no warranties, expressed or implied, is intended to be given as to the actual performance of the product mentioned or referred to herein and no liability whatsoever will be accepted for any loss, damage or injury arising from the use of the information given.

For all technical details on the products specified please refer to the technical data sheets that can be found on www.firestopcentre.co.nz

Signed and approved:

Sheet size: | Drawn date & no:

A4 | 24/5/21

Scale: | Drawn by:

NTS | **K.B**